

**PRELIMINARY PLAN ONLY.
SUBJECT TO FURTHER
REVISION AND CONSULTATION**

HEALTH & SAFETY INFORMATION

CONSTRUCTION, MAINTENANCE, OPERATION, DECOMMISSIONING AND DEMOLITION PHASES

- This drawing shall be read in conjunction with the Pre-Construction Information and any existing Health and Safety File(s) produced.
- In preparation of the construction method statements consideration should be given to the close proximity of any structures that may be affected by construction.
- The contractor shall refer to statutory undertakers' layout drawings and identify locations of existing overhead and underground services prior to carrying out excavation works.
- Refer to the designer's risk register and the works information for full details of the residual risks associated with this work. Significant residual risks are listed here and referenced on the drawing:

4.1.

© This drawing is Copyright. It should not be relied on or used in circumstances other than those for which it was originally prepared and for which Cornwall Council was originally commissioned. Cornwall Council accepts no responsibility for this drawing to any party other than the person(s) by whom it was commissioned.

NOTES:

- All dimensions are in metres unless otherwise stated.
- Do not scale from this drawing.

Key:

- Existing footway
- New footway in existing carriageway
- New footway in existing verge
- New footway over existing private drive
- Carriageway strip widening
- New grass verge
- Existing grass verge
- Flat top road hump
- HB2 kerb
- Dropped BN kerb
- Transition kerb
- Concrete edging
- Bus boarder kerb
- Transition bus boarder kerb
- Corduroy paving
- Tactile paving
- New signage location
- Bollard
- Relocated bus shelter
- New cycle stand
- Traffic island. Concrete infill.

REV	DATE	NATURE OF REVISION
P01	05/07/19	First Issue

REVISIONS		
REV	DATE	NATURE OF REVISION



CORMAC SOLUTIONS
RADNOR ROAD
SCORRIER
CORNWALL TR16 5EH
www.cormac.co.uk 01872 323 313

PROJECT TITLE:
Saltash Walking & Cycling Phase 1b

DRAWING TITLE:
General Arrangement (Sheet 2 of 3)
Burraton Cross to Church Road

SCALE: 1:500 @ A1

PROJECT MANAGER: AU	DRAWN BY: AK
CHECKED: AU	APPROVED: JHJ
DATE: 04/07/19	DATE: 05/07/19

DRAWING NO:
EDG1696 - ORIGINATOR - VOLUME - LOCATION
EDG1696 - CSL - HGN - SX418591

PROJECT REF: EDG1696 **DRAWING STATUS:** Preliminary **SUITABILITY:** S3 **REVISION:** P01

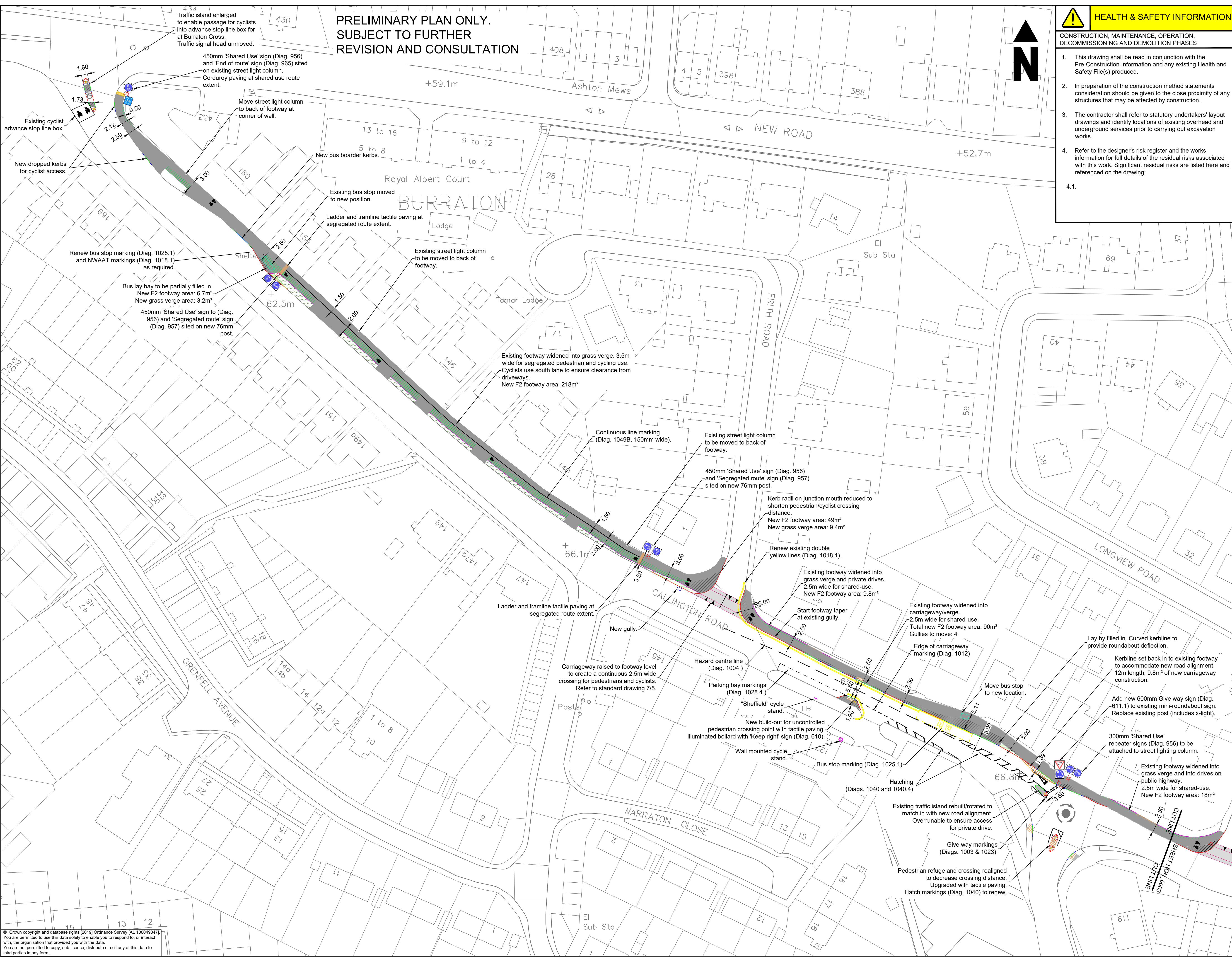

© Crown copyright and database rights [2019] Ordnance Survey [AL 100049047]
You are permitted to use this data solely to enable you to respond to, or interact with, the organisation that provided you with the data.
You are not permitted to copy, sub-licence, distribute or sell any of this data to third parties in any form.